

# Clinical Education Center at Brackenridge

A member of the Seton Family of Hospitals

1400 North IH-35 • Austin, Texas 78701 • Fax: 512-324-8033

[www.seton.net/cec](http://www.seton.net/cec)

**Yvonne VanDyke, RN, MSN**

CEC Administrator, Vice President of Nursing Education  
yvandyke@seton.org

Denise Jacoby  
Executive Assistant  
512-324-9999 ext. 80116

**Frank Mazza, MD**

Vice President / Chief Patient Safety Officer  
Associate Chief Medical Officer  
Medical Director of Simulation  
Seton Family of Hospitals

**Buffy Allen**

CEC Simulation Director  
bdallen@seton.org  
512-324-8114

**Janis Graef, MHA, CPA**

CEC Operations Manager  
jgraef@seton.org  
512-324-8200

**Ande Brophy**

CEC Scheduler  
albrophy@seton.org  
512-324-9999 ext. 80117

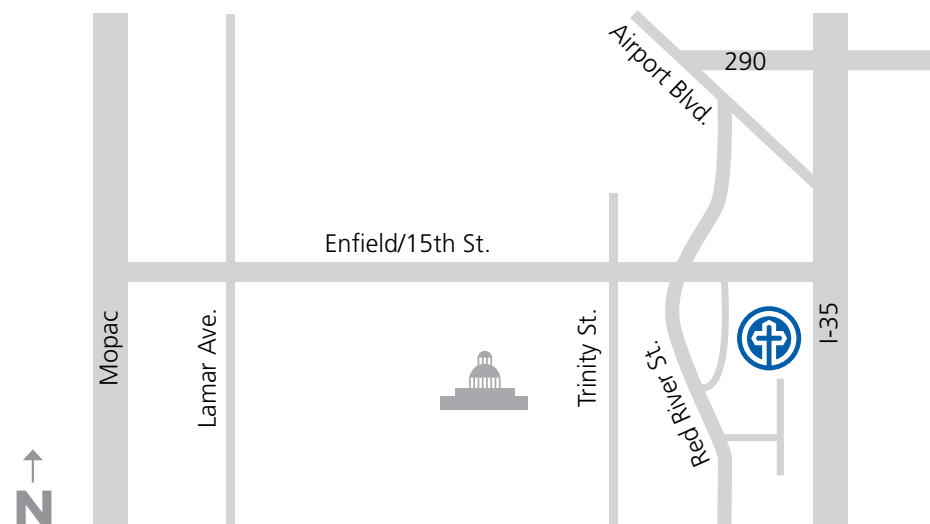

**Clinical Education Center Parking Garage:**

Located on the southbound IH-35 access road, the CEC parking garage is the first driveway past 15th Street. Badge Access is required, however, a parking attendant is available on-site.

**FLOOR 1**



**FLOOR 2**

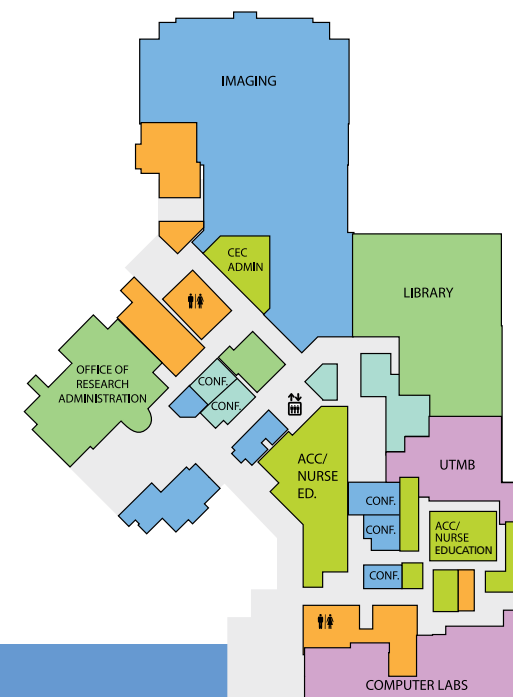

# BLUEPRINT

FOR MEDICAL INNOVATION



## Clinical Education Center at Brackenridge

A member of the Seton Family of Hospitals



**The Clinical Education Center**, located in Austin, Texas, adjacent to University Medical Center Brackenridge, is an exciting and innovative partnership involving the Seton Family of Hospitals, Austin Community College, Concordia University, the University of Texas Medical Branch-Austin Programs, the University of Texas at Austin and Texas Tech University.

In 2007, the Clinical Education Center was created by converting a modern, fully-functioning hospital into a state-of-the-art teaching facility. The CEC is loaded with breakthrough technologies — high fidelity interactive mannequins, skills labs, simulated and clinical environments.

To facilitate teaching clinical care in the 21st century, classrooms are wired with microphones, video cameras, wireless intercoms, and a whole host of leap-ahead instructional and simulation aids.

Study after study shows that the highest-quality patient healthcare flows from an interdisciplinary approach. The CEC is used by physicians, nurses, respiratory therapists and clinical assistants in collaboration with professionals from informatics, public health, bioengineering, social work, pharmaceutical, law, psychology and government.

One of the key goals of the CEC is to focus on major health issues facing most modern communities. The CEC has established team training and enhanced research in areas such as diabetes prevention, substance abuse, social medicine and health disparities, patient safety and disaster preparedness.

The CEC is also addressing another issue critical to Central Texas residents: the looming shortage of medical personnel throughout the region. The CEC will lead the way in establishing a steady resource of highly-trained clinicians so that the region can rely on a continued pipeline of top-level health care professionals in the decades to come.

The CEC is building a unique reputation as a one-of-a-kind facility for training, simulations, seminars and national conferences. The CEC is even gaining the attention of production companies who are interested in its realistic hospital sets.

The interdisciplinary focus, the use of the latest medical technology and simulators, the outstanding training environment...all these have placed the Clinical Education Center at the core of innovation and academic medicine.

### SETON'S VERSANT RN RESIDENCY

Hospitals must increasingly rely on new graduate RNs to staff existing beds and support future growth. Unlike medical school graduates who get training during formal residencies, most newly licensed nurses do not have similar protected training to build their skills and get used to the demanding environment. The stresses of navigating a new environment, working overnight shifts, and caring for acutely ill patients can take a significant toll, leading to high new graduate turnover rates. The Clinical Education Center offers Seton's Versant RN Residency to help new graduates successfully make the transition from student to nursing professional. The Versant RN Residency is an evidence-based RN Residency that develops new graduates' clinical and analytical skills, fosters practice improvement, and provides support that has proven to significantly increase the new RN's competence and confidence over traditional orientation methods.

### CHANGE IN HEALTHCARE EDUCATION MODEL

At the beginning of the 21st century, the Institute of Medicine (IOM)—a member of the National Academies of Science—released a report highlighting changes in the nation's healthcare systems. The IOM offered a blueprint to prepare the healthcare education community to better address these profound, generational changes in



health care. The Clinical Education Center at Brackenridge offers an instructional environment that embraces many of the IOM enhancements, including informatics, interdisciplinary teamwork, evidence-based practice, patient-centered care and quality improvement.

### COLLABORATION

Team-based medicine—an interdisciplinary approach to both training and treatment—is an emerging medical strategy that is both efficient and productive. The Clinical Education Center has established an ambitious goal: To become the most comprehensive interdisciplinary medical education program in the country. The innovative philosophy which drives the team-based approach is simple—healthcare practitioners from different medical disciplines learning to work together to solve patient problems do so more efficiently, and with a greater range of collective knowledge, than learning in separate schools.

### HI-FI MANEQUINS AND SIMS

The Clinical Education Center utilizes the latest simulation technology, including several high-tech mannequins. These devices with names like "SimMan," "SimBaby," "SimNewB," "Noelle" and "PediHal" provide realistic and challenging emergencies to test and enhance critical thinking and clinical skills. They offer wound modules and programmable physiology that adapt to medical intervention via sophisticated PC software with integrated video debriefing.

### FILMING AND CONFERENCES

The primary function of the Clinical Education Center is to bring together the environment and resources necessary to enhance the education of current and future healthcare professionals. However, that is not all that happens in the CEC. Because it is located in conference-friendly Austin, with numerous hotels and entertainment venues nearby, the CEC is becoming a popular conference location. Also, because of its unique clinical environment, the CEC offers a wide-range of medical and technical conferences. There are also the occasional lights, cameras, and action. The CEC is rapidly gaining a reputation as a ready-made set for medical training videos and hospital scenes. Several production companies have visited and taken advantage of filming in an established hospital.

### The Center features:

- Highly trained clinical and administrative staff.
- Flexible instructional spaces equipped with multimedia technology.
- Simulation labs to support interdisciplinary training.
- Medium to high-fidelity interactive mannequins that provide learners with a safe error forgiving environment to practice interdisciplinary team approach to patient care.
- Debriefing rooms to support the simulation labs.
- Skills Labs for learners to practice nursing and medical skills in a real life hospital setting.
- Computer lab and learning resource area



### Medical & Surgical Simulation Labs:

- The Clinical Education Center at Brackenridge has eight simulation labs to support interdisciplinary training.
- The simulation labs are configured as a labor and delivery room, operating room/catherization lab and an emergency room/intensive care unit.
- Each room includes microphones and video cameras.
- During full-scale simulations, instructors observe and coordinate faculty and medical actors through wireless intercoms, as well as modify the simulation in progress and provide a voice for the patient (through a speaker in the mannequin).



### Skills Labs:

- The Skills Labs provide opportunities for learners to practice patient care in a real life hospital setting.
- Learners develop skill proficiency and improve critical decision making through skill and scenario-based learning.

### FOR MORE INFORMATION

The Clinical Education Center at Brackenridge is a new and exciting facility with state-of-the-art teaching and simulation space.

If you are interested in how we can help you plan your next conference or seminar, contact Ande Brophy at (512) 324-9999 ext. 80117 or [albrophy@seton.org](mailto:albrophy@seton.org)

For more information about simulation or enhancing education modalities, please contact Buffy Allen at (512) 324-8114 or email [bdallen@seton.org](mailto:bdallen@seton.org)